

## REMEMBER

Maximum water supply pressure **5 bar (75PSI)** Minimum water supply pressure **1.0 bar**

Maximum hot water supply temperature **70°C**

Recommended hot water supply temperature **65°C**

If these temperatures or water pressure are exceeded, damage to the tap can result. A pressure reducing valve may be required to be fitted in high water pressure situations.

## AFTER CARE

To maintain the appearance of this tap, ensure that it is regularly cleaned only using a clean, soft damp cloth. A solution of warm water and a mild liquid detergent may be used where necessary, and then the fitting rinsed thoroughly and wiped dry. Abrasive cleaners, scouring cleaners and acid cleaners **must not be used** under any circumstances. All bath cleaning powders and liquids will damage the surface of your fitting even the non-scratch cleaners. Avoid contact with all solvents and any harsh household chemicals. You will damage the plated finish and void your guarantee.

## GUARANTEE AND LIABILITY

In the unlikely event that you should experience any defect in the material or workmanship of your mixer tap within 5 years of purchase, we will replace the faulty part free of charge. Decorative surface finishes are guaranteed for one year from the date of purchase provided that our advice concerning care has been observed and no scouring agents have been used. This is provided that the mixer or tap has been used for normal domestic purposes in the UK and that the care, installation and maintenance instructions have been observed.

Scuff and scratches caused by normal wear and tear, improper installation or accidental damage are excluded from this guarantee.

You should retain a copy of your dated invoice as proof of purchase to validate any claims under this guarantee.

No other warranties, express or implied, are made, including merchantability or fitness for a particular purpose.



Please Keep Me Safe

## Spare Parts and Service

**sterling**  
SINKS & TAPS

Contact: **Sterling**  
Phone: **01684 299555**  
Fax: **01684 290958**  
Email: **sales@sterling.eu.com**  
Website: **www.sterling.eu.com**

# TOLEDO

clearwater®  
THE CLEAR CHOICE



## Fitting Instructions and Parts List

Please read these instructions before you install and use the tap, be sure to keep them safe for future reference and to request replacement parts.

All designs, descriptions and dimensions are subject to change without notice.

## PARTS LIST TOLEDO

Ref. TO2

In the unlikely event you find a part missing please contact our Customer Service Helpline on 01684 299555 for immediate despatch of part.

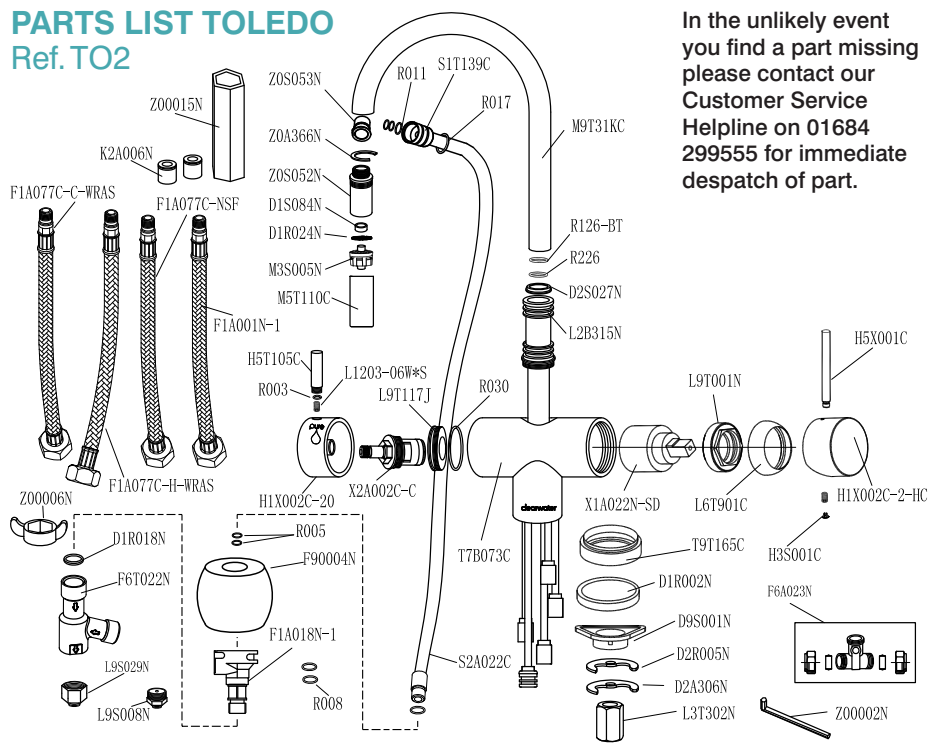

## MAINTENANCE

### IF THE FITTING BEGINS TO DRIP

- 1 Turn off the water supply
- 2 Loosen grub screw under handle lever, remove handle and valve
- 3 Carefully clean seating, rubber washer and ceramic disc
- 4 Replace valve and handle, then turn on the water supply
- 5 If problem persists contact our helpline quoting the product code

Where an aerator is fitted to the outlet of the spout, it will need occasional cleaning. This will be evident when the water flow slows down to an unacceptable level. To accomplish this unscrew the outlet in an anti-clockwise direction and remove the mesh. Immerse the mesh in a suitable descaling fluid overnight, rinse thoroughly in clean water and re-install.

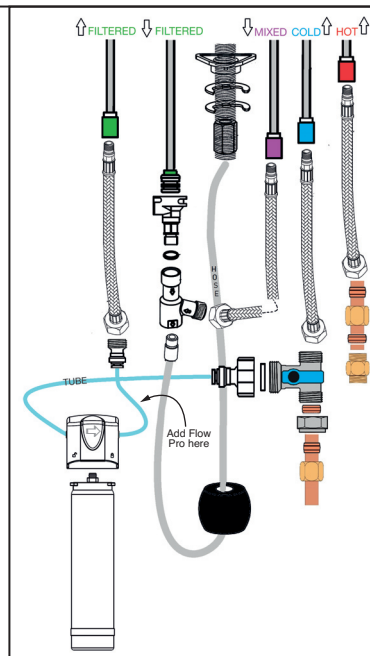

It is very important that you read through the following instructions **BEFORE** you install and use the tap.

## PREPARATION

We strongly recommend installing particle filters and isolation valves to both hot and cold feeds. This will help to prevent premature failure of valves and make any future maintenance easier.

Flush the plumbing system before installing the mixer tap. This is to void plumbing residues clogging the mesh of the aerated outlet, or possibly damaging the valve's washers. This is especially important where extensive plumbing work has been carried out.

First shut off your water heating system then, with your mains stop cock closed, open the lowest hot and cold taps in the house and allow to run until the cold storage tank and pipes are empty. (The hot water storage cylinder always remains full).

## INSTALLATION

**Firstly prepare the area, isolate water supplies and plan your plumbing layout as per the Diagram at the bottom of left hand page.**

Place the base ring and seal on the base of the tap and then slide the tap through the tap hole.

Connect the fixings to the threaded fixing shaft, making sure the seal side is first. Use the triangle fixing bracket if the sink / worktop is less than 20mm thick. Tighten fixing nut.

Attached the tails to the relevant colour coded rigid pipes, use the diagram for further reference.

Connect the chrome three way tee with isolation valve to the bottom of the cold flexi tail.

Connect the 1/2" male x 1/4" push connector to the flexi tail that connects to the green inlet rigid pipe.

Connect the 1/2" female x 1/4" connector & clear 1/2" seal to the chrome three way tee.

Position the filter head in the cupboard vertical giving space to remove the filter and attached the filter head to the carcass, using the screw provided.

Cut the quarter inch pipping into three section allowing for your positioning of the FlowPro.

Attach the filter to the filter head. Push in and twist to install.

Push the white tube into the chrome three way tee and the inlet ( left side ) of the filter head.

Add a short run of white tubing then install the Flow pro and sensor. Make sure the flow is in the correct direction as mark on the sensor and only hand tight the fittings (over tightening will reduce the flow rate).

Push the last section of tubing to the outlet of the sensor and into the green inlet tail.

Attach the Brass three way tee with green and purple marking, to the pull out hose. Screw the purple marked tail to the purple marked side of the brass tee.

Connect the counter weight to the pull out hose as per the diagram depicts.

Connect the hot and cold to the mains supply's, check all connections are tight by hand only.

Turn on the isolations and check for leaks.

### FOR BEST RESULTS

Run off around 5 litres of water from the filter line prior to drinking.

Reduce the filter water flow to around 2 litres per minute by adjusting the 3 way tee shut of valve (27916). This will maximise the filter contact time.

The filter must be changed at least every 12 months. We suggest changing the cartridge every 6 months in normal household usage (filter life 4000 litres usage).

### USING OTHER FILTERS/WATER SOFTENING SYSTEMS

Make sure that the filter line isn't over pressurised, as this filter line is only designed for a maximum of 4 litres per minute and may fail if over pressurised. Install a pressure reducing valve in such instances.

### OTHER

Remember to fill in and send off your freepost warranty form.