

GUARANTEE - Please visit www.perrinandrowe.co.uk/register, complete the supplied freepost card or phone 01708 526 361 to register your product.

Your product has been manufactured to exacting standards. However, in the unlikely event that you should experience any defect, the following guarantees will apply:

The tap is guaranteed against any material or workmanship defect within five years of the date of purchase. Should a fault occur; a replacement part will be issued. The tank is guaranteed against any material or workmanship defect within two years of the date of purchase, NB the filtration cartridge must be replaced every six months. The surface finish of the products are guaranteed for one year from the date of purchase. This is provided our care and maintenance instructions have been followed and that no scouring or aggressive cleaning agents have been used.

This does not affect your statutory rights.

CARE & MAINTENANCE

- To ensure optimum performance the filter cartridge must be replaced every six months.
- Ensure the complete installation is checked for any signs of leakage, wear or damage.
- When cleaning the tap ensure that the tank is switched off.
- Wipe the tap with a soft cloth after use to avoid water spotting and mineral build up.
- Occasional cleaning with warm soapy water, followed by a polish with a soft cloth is all that is required to keep the plated finish in good condition.

Do not use proprietary abrasive liquids, powders, or pads to clean the tap. Do not use products with ammonia bleach or limescale remover. You may damage the plated finish and void your guarantee.

SPARES

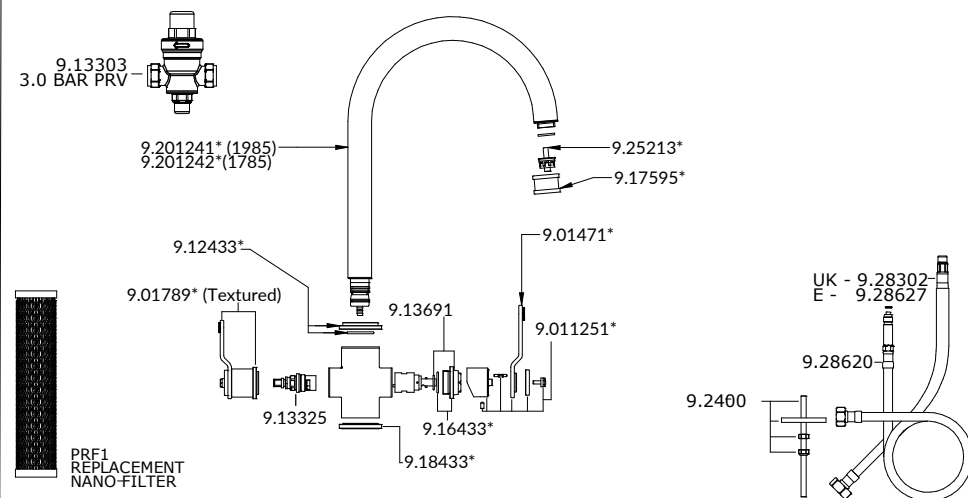

* Where Indicated Specify Colour

SPARE PARTS & SERVICE

PERRIN & ROWE
MAY FAIR LONDON

Phone: 01708 526 361

enquiries@perrinandrowe.co.uk
www.perrinandrowe.co.uk

Perrin & Rowe products are manufactured in the UK, using the latest technology and built to the highest quality standards.

We would like to thank you for purchasing a Perrin & Rowe product and take this opportunity to invite you to look at other luxury products by us. Please contact us to receive our latest product catalogue.

PERRIN & ROWE
MAY FAIR LONDON

IMPORTANT WARNING!!

PLEASE ENSURE THAT THE RECOMMENDED TANK UNIT IS USED.

TO AVOID PRESSURISED BOILING WATER AND TO COMPLY WITH UK BYELAWS THIS IS AN OPEN VENTED PRODUCT.

DO NOT PLUG IN THE UNIT UNTIL ALL WATER CONNECTIONS HAVE BEEN MADE AND THE TANK HAS FILLED COMPLETELY THEN FLUSHED TO REMOVE AIR.

ENSURE PRESSURE REDUCING VALVE (PRV) IS USED INLINE WITH COLD INLET, FAILURE TO DO SO MAY RESULT IN REDUCED PRODUCT PERFORMANCE.

INSTANT HOT WATER TEMPERATURES CAN REACH 98°C. THE TAP IS DESIGNED WITH FEATURES TO MINIMISE RISK AND POTENTIAL INJURY; TWO ACTION OPERATION, SPRING BACK VALVE AND DELAYED DELIVERY; BUT SHOULD BE OPERATED OR SUPERVISED BY A RESPONSIBLE ADULT.

PLEASE READ AND FULLY UNDERSTAND THE HEATER TANK INSTRUCTIONS BEFORE USE.



The Armstrong Kitchen Collection Installation & User Guide

- 1985HT - Armstrong 3-IN-1

GUARANTEE - Please visit www.perrinandrowe.co.uk/register, complete the supplied freepost card or phone 01708 526 361 to register your product.

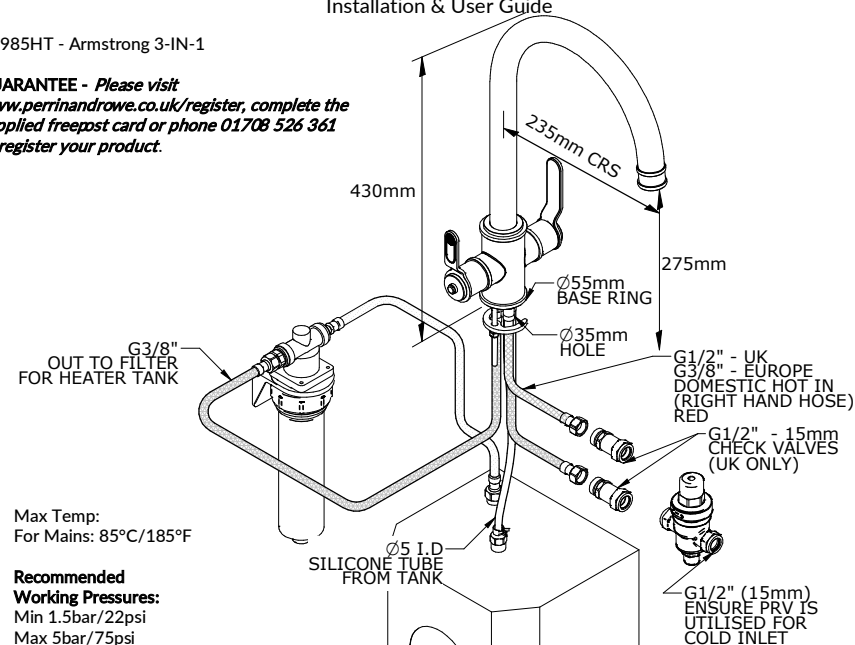

Max Temp:
For Mains: 85°C/185°F

Recommended Working Pressures:
Min 1.5bar/22psi
Max 5bar/75psi

Important! Ensure Pressure Reducing Valve (PRV) is used inline with cold inlet, failure to do so may result in reduced product performance .

PERRIN & ROWE INDUSTRIAL KITCHEN COLLECTION INSTALLATION & USER GUIDE



Congratulations on the purchase of your new kitchen mixer. Correctly installed and with sensible care, this product will give you many years of trouble-free service.

• IMPORTANT INFORMATION •

Before you proceed... We recommend you engage the services of a registered plumber to install this product.

For ease of possible future servicing, we also recommend the fitting of conveniently placed isolating valves.

In addition to the guide below it is essential that the written information overleaf is carefully read and understood.

• Preparation Check Box for Installer •

- | | |
|---|--|
| <input type="checkbox"/> Flush the plumbing system before installing the kitchen product. | <input type="checkbox"/> Once unpacked, remove nuts and clamping plate ready for installation. |
|---|--|

1

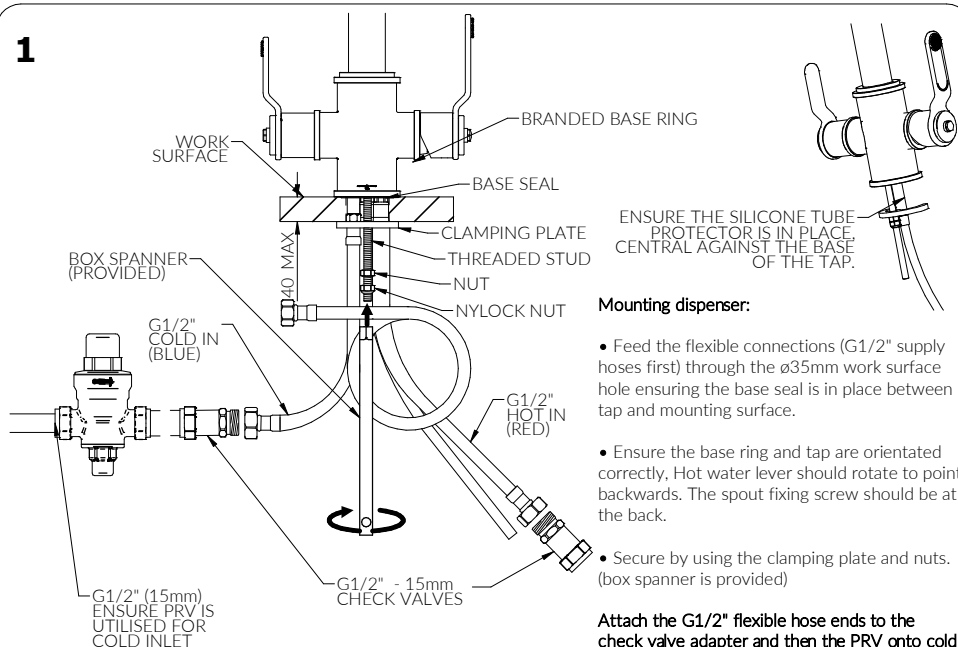

Mounting dispenser:

- Feed the flexible connections (G1/2" supply hoses first) through the ø35mm work surface hole ensuring the base seal is in place between tap and mounting surface.
- Ensure the base ring and tap are orientated correctly, Hot water lever should rotate to point backwards. The spout fixing screw should be at the back.
- Secure by using the clamping plate and nuts. (box spanner is provided)

Attach the G1/2" flexible hose ends to the check valve adapter and then the PRV onto cold inlet only (ensure arrow direction corresponds to correct direction of water flow).

- Rear braided hose - Cold Supply
- Right braided hose - Hot Supply

Ensure all connections are firmly tightened.

Consult the guide provided with the heater tank to ensure correct positioning and installation.

2

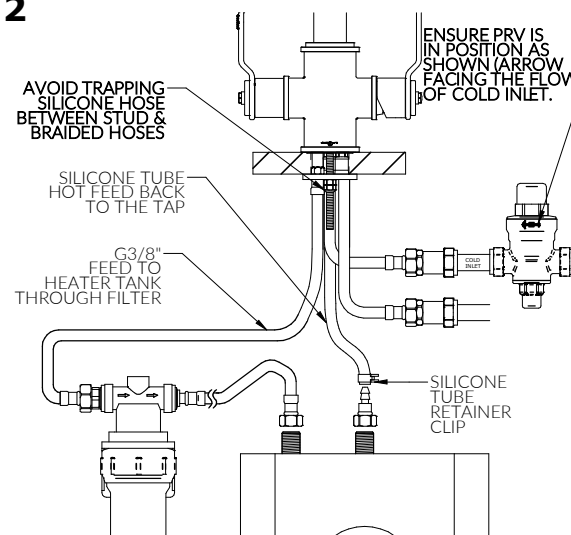

Connections to the filter and heater tank:
See separate filter guide for further instructions

- Mount the filter housing in an accessible location using either screws in the bracket or the adhesive pad, ensuring the mounting area is clean by using the wipe provided.

- Once the mains connections are made fit the G3/8" braided hose to the filter as shown.

- Connect the silicone tube to the barbed connection on the top of the heater tank as shown. (SEE NOTE 3)

IMPORTANT: During installation the tank should remain unplugged. The tank must be filled with water before power is connected. A 'dry start' will void the warranty.

Avoid kinking tubes during installation as the resulting restrictions could reduce flow and cause malfunctioning of the expansion chamber. Do not use pipe sealing compounds on any connections. These can foul the internal mechanics and may cause objectionable taste and odor. Plumbing connections must comply with all sanitary, safety and plumbing codes.

3 Silicone Hose

Trim the silicone hose to the right length for the installation. It must not be pulled taught, too slack leading to a 'U' bend or twisted. Please make sure the tube isn't pinched between the threaded stud and the braided hose as this may cause flow restriction. If the silicone is not installed correctly it may effect the performance of the system.

CORRECT

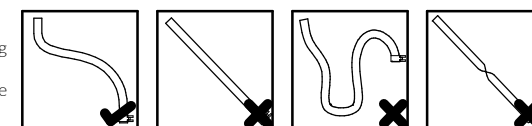

4 Operation

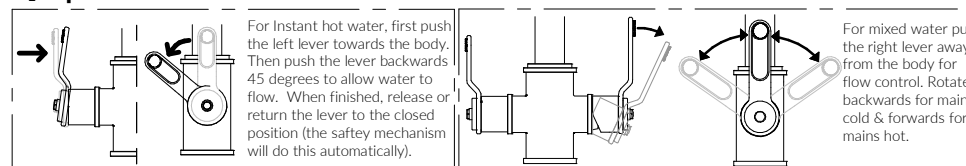

For instant hot water, first push the left lever towards the body. Then push the lever backwards 45 degrees to allow water to flow. When finished, release or return the lever to the closed position (the safety mechanism will do this automatically).

For mixed water pull the right lever away from the body for flow control. Rotate backwards for mains cold & forwards for mains hot.

IMPORTANT - BEFORE USE

- Carefully check the installation for leaks.
- If further building work is to be carried out in the vicinity, cover the product to avoid damaging the finish.
- Please ensure that the installation complies with local plumbing codes.