

**Serie | 8, Washing machine, front loader, 10 kg, 1600 rpm
WAX32GH4GB**



The ultimate washing machine with Home Connect, AntiStain Plus System and 4D Wash System with Intensive Plus provides spotless results with every load in the smartest way.

- **AntiStain Plus:** removes up to 16 kinds of stubborn stains without pre-treatment.
- **4D Wash System:** highly efficient water and detergent penetration for spotless results.
- **Home Connect:** home appliances with smart connectivity for an easier everyday life.
- **EcoSilence Drive™:** quiet and energy-efficient drive, with a 10-year warranty.
- **AllergyPlus:** developed for allergy sufferers and people with sensitive skin.

Technical Data

Energy Efficiency Class: C

Weighted energy consumption in kWh per 100 washing cycles of eco 40-60 programme: 67 kWh

Maximum capacity in kg: 10.0 kg

The water consumption of the eco programme in liters per cycle: 49 l

Duration of eco 40-60 programme in hours and mins at rated capacity: 3:55 h

Spin-drying efficiency class of eco 40-60 programme: A

Airborne acoustical noise emission class: A

Airborne acoustical noise emissions : 72 dB(A) re 1 pW

Construction type: Free-standing

Height of removable worktop: -2 mm

Dimensions of the product: 848 x 598 x 590 mm

Net weight: 81.9 kg

Connection rating: 2300 W

Fuse protection: 10 A

Voltage: 220-240 V

Frequency: 50 Hz

Approval certificates: CE, E17D UKCA marking, VDE

Length of electrical supply cord: 210 cm

Door hinge: Left

Wheels: No

Power consumption standby/network: Please check the user manual for how to switch off the WiFi module.: 1.5 W

Time auto-standby/network: 5.0 min

EAN code: 4242005243259

Installation type: Free-standing

Optional accessories

WMZ2200 : Floor securing component

WMZ2381 : Extension for cold water inlet /Aquastop



4 242005 243259

Serie | 8, Washing machine, front loader, 10 kg, 1600 rpm WAX32GH4GB

The ultimate washing machine with Home Connect, AntiStain Plus System and 4D Wash System with Intensive Plus provides spotless results with every load in the smartest way.

Performance

- Energy Efficiency Class¹: C
- Energy² / Water³: 67 kWh / 49 litres
- Load capacity: 1 - 10 kg
- Programme duration⁴: 3:55 h:min
- Spin drying efficiency class: A
- Spin speed^{**}: 400 - 1600 rpm
- Noise level: 72 dB (A) re 1 pW
- Noise efficiency class: A
- Drum volume: 70 litres

Programmes/functions

- Touch control buttons: Prog 3 sec., On/off, Ready in, stain selection, Intensive Plus, options, Remote Start, start/pause with reload function, Temperature selection, SpeedPerfect, Spin speed reduction/Rinse Hold
- Options: 1 - 3 additional rinse cycles, Easy iron, Soaking, AntiStain +, Intensive Plus, Night Wash, SpeedPerfect, Rinse hold, Prewash, Water plus
- Standard programmes: cottons, easy care, delicates, wool hand wash
- Special programmes: Allergy +, Drain, Drum clean with reminder, Towels, Shirts, Quiet Wash, Dark Wash, Spin, Mixed Load, Sportswear, Single Rinse, Super Quick 15/30
- Safeguard monitoring system adjusts load distribution and programme settings to protect clothes

Key features

- 4D Wash System: highly efficient water and detergent fabric penetration for spotless results.
- Home Connect: Remote Monitoring and Control, Energy Management
- AntiStain with 16 stain options
- Reload function: Flexibility in adding laundry items into the drum, even after the wash cycle has started.
- EcoSilence drive with 10 year warranty
- AntiVibration Design - for more stability and quietness
- EcoBar Plus function: five possible levels of energy and water consumption

Additional features

- TFT display: Clear text and high resolution for easy use with display of programme indication, temperature selection, spin speed, remaining time, 24 hour time delay and consumption indication
- Metal Control dial with integrated On / Off mode
- VarioDrum: gentle and efficient washing
- Drum interior light
- Drum clean with reminder function
- Sound insulation by additional noise reduction material
- Consump indicator energy+water, Load scale and detergent dosage recommendation, AntiStain
- Multiple Water Protection
- Foam detection system
- Overdosage indication
- Child lock
- Multi-tone acoustic signal to indicate end of cycle

Technical Information

- Slide-under installation
- Large chrome, white door with 180° opening
- Dimensions (H x W): 84.8 cm x 59.8 cm
- Appliance depth: 59.0 cm
- Appliance depth incl. door: 63.2 cm
- Appliance depth with open door: 108.5 cm

¹ Scale of Energy Efficiency Classes from A to G

² Energy consumption in kWh per 100 cycles (in programme Eco 40-60)

³ Weighted water consumption in litres per cycle (in programme Eco 40-60)

⁴ Duration of Eco 40-60 programme

^{**} Values are rounded.

**Serie | 8, Washing machine, front loader, 10
kg, 1600 rpm
WAX32GH4GB**

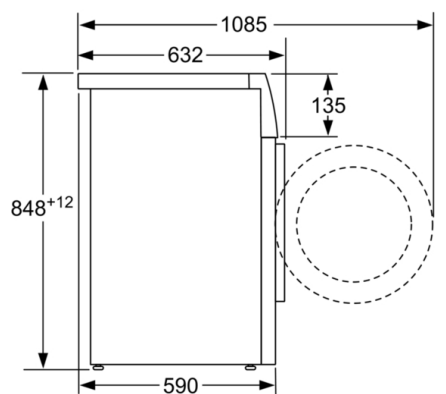

measurements in mm

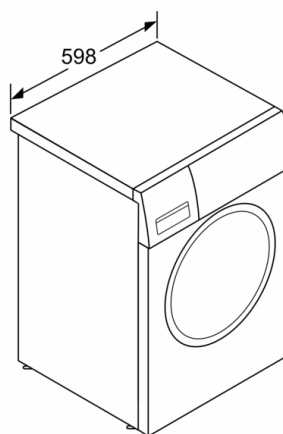

measurements in mm