

Fragranite Stone Grey | 114.0573.802

FAMILY : Sinks | SERIES : Urban | MODEL : UBG 611-100 | FINISH : Fraganite Stone Grey | INSTALLATION TYPE : Inset |
INSTALLATION TYPE : Flushmount | INSTALLATION TYPE : Active Twist Compatible

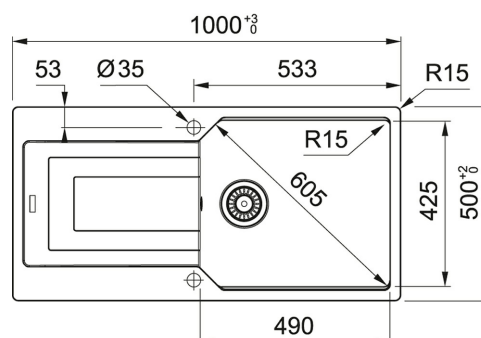

With the Franke Urban coloured sink you won't need to ask for help with the washing-up. It's so convenient and even fun to work in and around these stylish sinks that your guests or family members will happily ignore the dishwasher and volunteer to wash the dishes by hand. At least they will enjoy the look and feel of a modern and functional sink while using it.

These ultra-modern sinks are made of Fraganite, an extremely solid and easy-to-clean material consisting of 83 percent quartz and 17 percent acrylic resin. The colour is thermochemical bonded to the quartz particles, so it looks new and untouched for ever.

Franke Urban sinks come in various bowl sizes, designed to be installed as a bold inset and has an optional Strainer Bowl available. The wide choice of colours, means you can easily match the sink with the rest of your kitchen.

Take a look at our Urban videos on our YouTube channel at www.youtube.com/UKFranke

TECHNICAL DATA

Depth of large bowl	220.00 mm
Length of large bowl	490.00 mm
Width of large bowl	425.00 mm
Length Overall	1,000.00 mm
Width Overall	500.00 mm
Cutout Length	964.00 mm
Cutout Width	464.00 mm
Cabinet Size	600.00 mm
Cutout radius	R: 15 mm
Type of Material	FRAGRANITE
Position of Drainer	Reversible
Price	£467.00

FEATURES

Inset

Fragranite Stone Grey | 114.0573.802

FAMILY : **Sinks** | SERIES : **Urban** | MODEL : **UBG 611-100** | FINISH : **Fragranite Stone Grey** | INSTALLATION TYPE : **Inset** |
INSTALLATION TYPE : **Flushmount** | INSTALLATION TYPE : **Active Twist Compatible**

RECOMMENDED



112.0538.950



112.0059.946



134.0473.235



115.0567.593
