

Bridge Lever | 115.0049.963

FAMILY : Taps | SERIES : Bridge | MODEL : Bridge Lever | INSTALLATION TYPE : Sink/Worktop | FINISH : Decor Steel

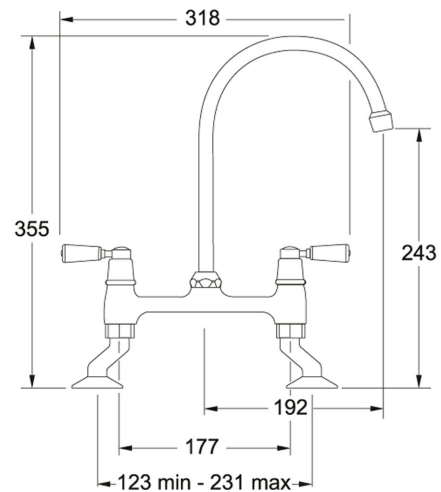

NB: FROM APRIL 2022 SILKSTEEL FINISH IS KNOWN AS DECOR STEEL

TECHNICAL DATA

Version	Swivel Spout
Handle Width	318.00 mm
Height Overall	355.00 mm
Height to End of Spout	243.00 mm
Spout reach	192.00 mm
Hot Flow Rate at 0.3 bar	6.15 litres/min
Suitable for low pressure system	Yes
Remarks	Important: This tap cannot be fitted to a single hole inset sink.
Remarks	This tap cannot be fitted to a single hole inset sink. Tap requires 2 x 25mm diameter tap holes.
Tap Operation	2-Hole
Type of Material	PLATED-BRASS
Type	Quarter Turn Ceramic Disc
Tap Pressure	Low Pressure
Price	£363.00