

**Serie | 6, Built-in double oven,
Stainless steel
MBA5575S0B**

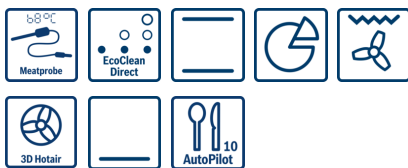

Included accessories

3 x combination grid
1 x universal pan

Optional accessories

HEZ531000 : Baking tray, grey enamelled
HEZ531010 : Baking tray, non-stick ceramic coated
HEZ538000 : 1fold telescopic rail, level independent
HEZ634000 : Baking and roasting grid (standard)
HEZ638300 : 3 level telescopic rails, full ext
HEZ915003 : Glass roasting dish, 5,4 L



**The built-in double oven with 3D hot air:
achieve perfect baking and roasting results
on multiple levels simultaneously.**

- **The built-in oven with meatprobe and AutoPilot:** automatically prepares your dishes to your liking
- **3D Hotair:** perfect results thanks to optimal distribution of heat on up to 3 levels simultaneously.
- **AutoPilot 10:** every dish is a perfect success thanks to 10 pre-set automatic programmes.
- **LCD display control, white:** easy-to-use thanks to direct access to additional functions.
- **EcoClean Direct:** almost no cleaning is necessary thanks to a special coating of the rear- and side wall and the roof that cleans itself and has a regeneration programme.
- **Level independent telescopic rail:** can be placed in any cooking level.

Technical Data

Color / Material Front :	Stainless steel
Construction type :	Built-in
Integrated Cleaning system :	No
Dimensions of the product (mm) :	888 x 594 x 550
Dimensions of the packed product (HxWxD) (mm) :	960 x 690 x 660
Control Panel Material :	Stainless steel
Door Material :	Glass
Net weight (kg) :	53.383
Usable volume of cavity (l) :	71
Cooking method :	Bottom heat, Conventional heat, Full width grill, Hot Air, Hotair gentle, Hot air grilling, Pizza setting
Temperature control :	No control of the temperature
Number of interior lights :	1
Approval certificates :	CE, VDE
EAN code :	4242005057627
Energy efficiency class (2010/30/EC) :	A
Energy consumption per cycle conventional (2010/30/EC) :	1.02
Energy consumption per cycle forced air convection (2010/30/EC) :	0.81
Energy efficiency class (2010/30/EC) - cavity 2 :	B
Energy consumption per cycle conventional - cavity 2 (2010/30/EC) :	0.83
Energy efficiency index (2010/30/EC) :	95.3
Energy efficiency index cavity 2 (2010/30/EC) :	120.3
Connection rating (W) :	5900
Current (A) :	32
Voltage (V) :	220-240
Frequency (Hz) :	50
Plug type :	fixed connection, no plug



Serie | 6, Built-in double oven, Stainless steel MBA5575SOB

**The built-in double oven with 3D hot air:
achieve perfect baking and roasting results
on multiple levels simultaneously.**

Design

- LCD-display control (white)
- Straight bar handle
- Retractable control dials, Rotary dial

Main Lower oven

- Cavity volume: 71 litre capacity
- Smooth enamelled oven interior, Removable wire shelf support rails
- Halogen interior light
- Heating-up indicator
- Control panel lock
Residual heat indicator
- AutoPilot10
- Single-point meat probe

Cleaning

- EcoClean Direct : side liners, back panel, ceiling
- EcoClean Direct programme
- Full glass inner door

Programmes/functions

- Oven with 7 heating methods: 3D hot air, conventional top and bottom heat, Hotair grilling, full width variable grill, pizza function, bottom heat, Hotair gentle
- Fast pre-heating function

Secondary top oven

- Cavity volume: 34 litre capacity
- Smooth enamelled oven interior, Removable wire shelf support rails
- Halogen interior light

Programmes/functions

- Oven with 4 heating methods: conventional top/bottom heat, Large-area grill, Small area grill, bottom heat

Cleaning

- EcoClean Direct :side liners, ceiling, back panel
- Full glass inner door

Accessories

- 3 x combination grid, 1 x universal pan
- 1 set of level independent telescopic rails, Stop function

Performance/technical information

- Energy efficiency rating (acc. EU Nr. 65/2014): A
Energy consumption per cycle in conventional mode: 1.02 kwh
Energy consumption per cycle in fan-forced convection mode: 0.81 kwh
Number of cavities: Main cavity
Heat source: electrical
Cavity volume: 71 litre capacity
- Energy efficiency rating (acc. EU Nr. 65/2014): B
Energy consumption per cycle conventional mode: 0.83 kwh
Number of cavities: Top Cavity
Heat source: electrical
Cavity volume: 34 litre capacity
- Nominal voltage: 220 - 240 V
- Appliance dimension (hxwxh): 888 mm x 594 mm x 550 mm
- Please refer to the dimensions provided in the installation manual

**Serie | 6, Built-in double oven, Stainless steel
MBA5575S0B**

