

Titane Professional Style Mixertap

abode

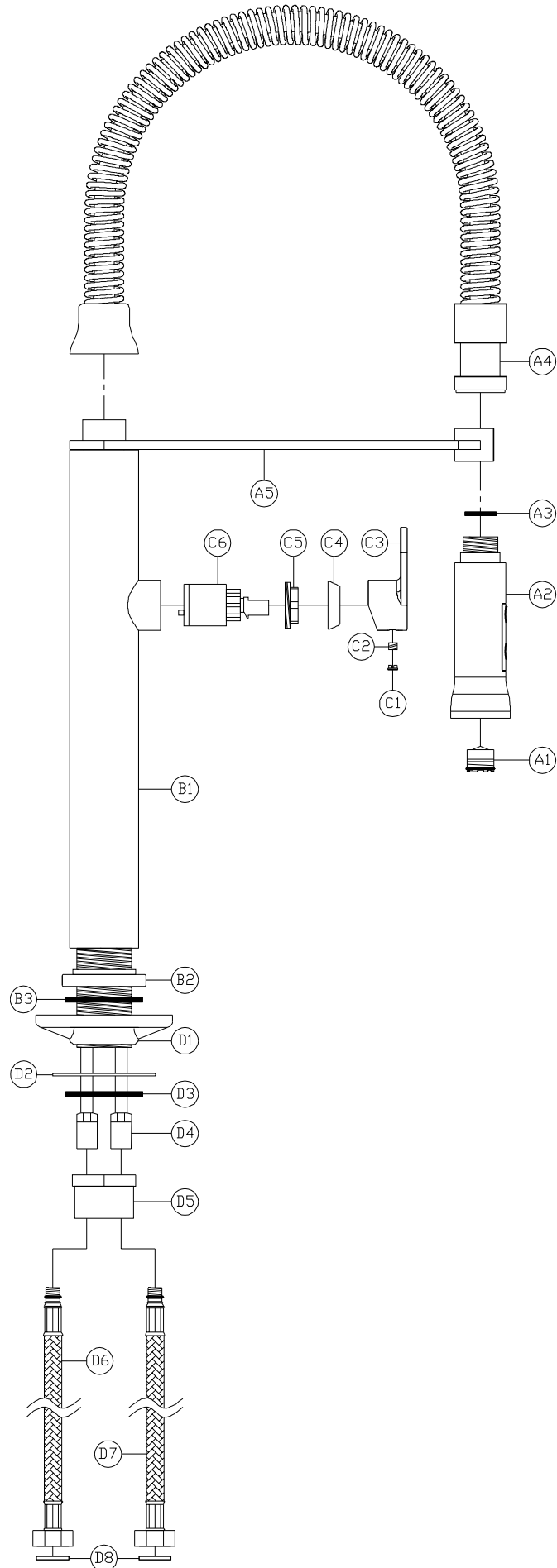

Titane Professional Style Mixertap

abode

General Advice:

- These instructions are intended as a guide only, if you are in any doubt you should seek the advice of a qualified professional.
- Take care not to mark finished parts with screwdrivers or other tools.
- Use a pair of rubber gloves to get a better grip on decorative hand tight parts.
- Ensure all parts are reassembled tightly.
- After maintenance test that all assemblies are water tight and function correctly.
- Always isolate the hot and cold water supplies before starting any maintenance, once isolated you should drain any residual water from your system.

To replace the valve:

1. Lever out the dust cap (C1) using a small precision screwdriver or fingernail.
2. Unscrew the grub screw (C2) using a 2.5mm A/F Allen key.
3. Pull handle (C3) horizontally away from the body (B1).
4. Unscrew the decorative cover (C4) horizontally away from tap body (B1) by hand.
5. With the tap (B1) fixed to the sink/base unit, using an adjustable spanner unscrew the valve lock nut (C5).
6. Clean the Inside of chamber (B1) with a soft wet cloth.
7. Replace the faulty valve (C6) with the new one and assemble in reverse order.