



# TRIPURO

PREMIUM FILTER SYSTEM

## WARRANTY

TRIPURO systems (excluding replacement cartridges) are covered by a limited warranty against defects in material and workmanship for a period of 5 years after date of purchase.

Replacement cartridges are covered by a limited warranty against defects in materials and workmanship for a period of 1 year after date of purchase. *(Subject to registration).*



## Valved Head Installation Guide

For optimal performance, please follow the instructions in this installation guide. Using a **TRIPURO** system outside of these operating parameters may result in poor performance and could invalidate the warranty.

- 1 Select the 'snap fit' or rotary wall plate mounting. *Please note, the rotary wall plate should be used if varying positions are required.*

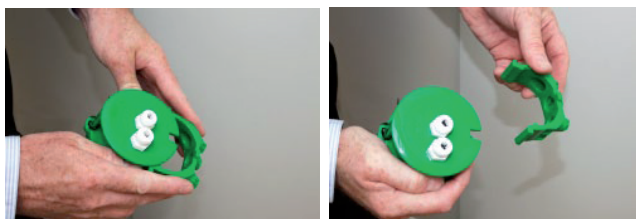

- 2 Measure & mark the centres of your desired filter location.



- 3 Screw the 'snap fit' bracket or rotary wall plate into the marked location. If the rotary wall plate option has been used, attach the bracket to the wall plate at the required angle, using the screw provided. Always ensure the location lug is pointing upwards.

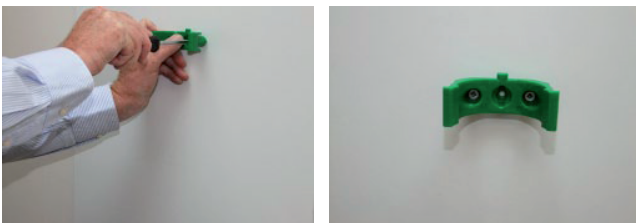

- 4 Locate the filter head into the bracket until you feel it click into place (it will only fit one way – with the black location arrows directly facing you).



- 5 The filter feeds from the outer most push fit fitting (on the right when viewed from the front, marked 'in'). Cut the 1/4" O.D. inlet/outlet tubing (not supplied) to the correct lengths, ensuring the cut ends are square and clean.

A – Fit the outlet tubing to the 'out' connector.

B – Fit the inlet tubing to the 'in' connector.

To remove a tube, simply push down on the collet whilst pulling on the tubing.



- 6 Turn on the water supply and check for leaks. It is recommended that you flush at least 2 litres of water through the system. Write the installation and filter change dates on the label.



## Warning

Do not use with water that is microbiologically unsafe or of unknown quality without adequate disinfection before or after the system. Install in cold water applications only. The contaminants removed by this water filter are not necessarily present in all water. Systems certified for cyst reduction may be used on disinfected water that may contain filterable cysts.

For cooler applications only, not intended for use in general plumbed-in applications.

We recommend regular replacement of the filter cartridges – change the cartridge at least every 6 months.

Do not install if water pressure exceeds 120psi. If your water pressure exceeds 80psi, you must install a pressure limiting valve. Do not install where water hammer conditions may occur. If water hammer conditions exist you must install a water hammer arrester. Contact a plumbing professional if you are uncertain how to check for these conditions. Installation and use must comply with all state and local plumbing laws and regulations. Improper installation may result in property damage due to water leakage.



## Installation/Replacement Tips

- On installation allow room around the clamp ring to grip and rotate
- Minimum 30mm vertical clearance below base of housing for cartridge change
- On replacing cartridge in sump, align arrow on cartridge top metal plate with arrow on sump – insert and rotate clockwise as per "IN" arrow to stop
- To reconnect to head, align arrows on head and sump, push sump into head and rotate clamp ring anti-clockwise
- Apply new change date label over existing main product label

## Operation Tips

- Change cartridge at not more than 6 monthly intervals
- Change cartridges when capacity is reached or when pressure falls below 10psi
- Flush for 2 minutes following initial installation and cartridge change