

IMPORTANT WARNING!!



PLEASE ENSURE THAT THE RECOMMENDED TANK UNIT IS USED.

TO AVOID PRESSURISED BOILING WATER AND TO COMPLY WITH UK BYELAWS THIS IS AN OPEN VENTED PRODUCT.

DO NOT PLUG IN THE UNIT UNTIL ALL WATER CONNECTIONS HAVE BEEN MADE AND THE TANK HAS FILLED COMPLETELY THEN FLUSHED TO REMOVE AIR.

PLEASE READ AND FULLY UNDERSTAND THE HEATER TANK INSTRUCTIONS BEFORE USE.

3 in 1 Sink Mixer with Instant Hot Water

S.1003/H1

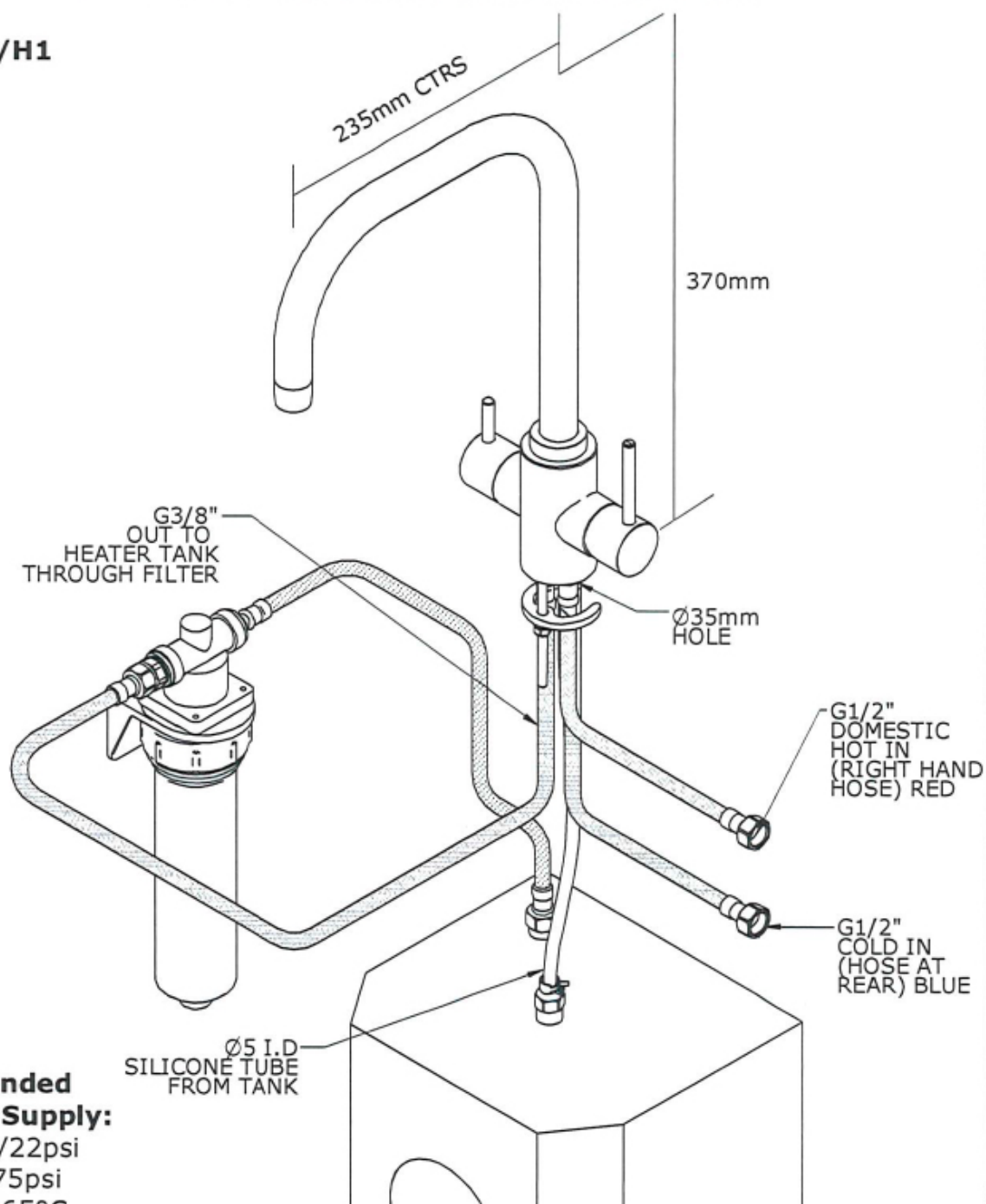

Recommended Domestic Supply:

Min 1.5bar/22psi

Max 5bar/75psi

Max Temp 65°C

Congratulations on the purchase of your new kitchen mixer. Correctly installed and with sensible care, this product will give you many years of trouble free service.

IMPORTANT INFORMATION

Before you proceed... We recommend you engage the services of a registered plumber to install this product.

For ease of possible future servicing, we also recommend the fitting of conveniently placed isolating valves.

In addition to the guide below it is essential that the written information overleaf is carefully read and understood.

**** IMPORTANT NOTICE ****

In order to ensure the product continues to deliver the highest quality drinking water and the heater tank is protected from lime scale build-up, the filter must be replaced every 6 months - failure to do so may invalidate your product warranty.

Please ensure your product is registered by completing the attached Free Post registration card to join our free replacement filter reminder service. If in doubt please contact:

Preparation Check Box for Installer



Flush the plumbing system before installing the kitchen product.



Once unpacked, remove nuts and clamping plate ready for installation.

1

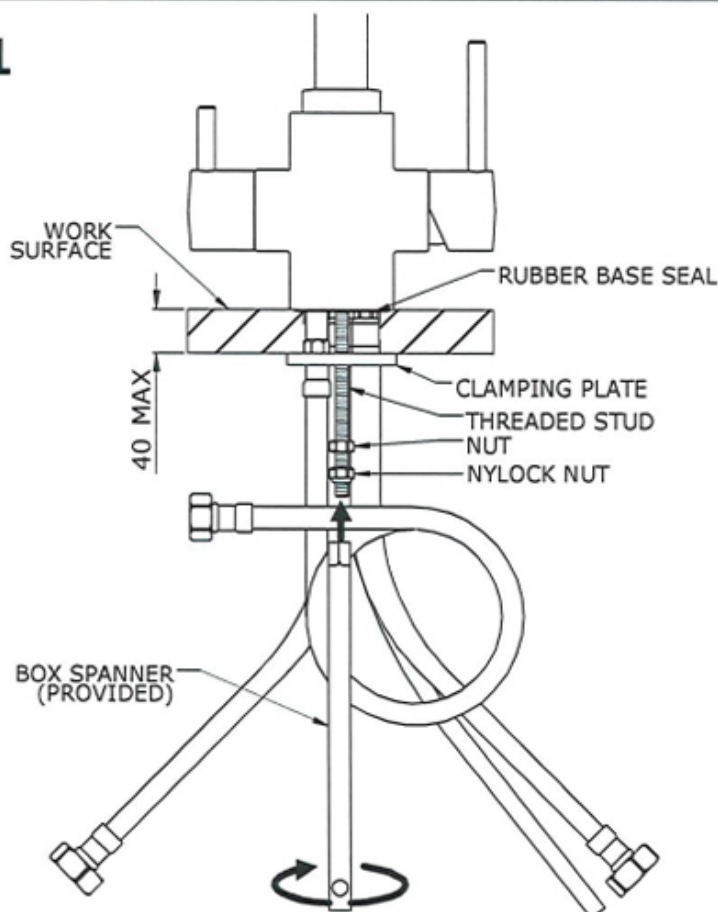

Mounting dispenser:

- Feed the flexible connections through the work surface hole Ø35mm, ensuring the base seal is in place between tap and mounting surface.
- Ensure the tap is orientated correctly, Hot water lever should rotate to point backwards. The spout fixing screw should be at the back.
- Secure by using the clamping plate and nuts. (box spanner is provided)

Attach the G1/2" flexible hose ends to the appropriate mains supply connections:

- Rear braided hose - Cold Supply
- Front braided hose - Hot Supply

Ensure all connections are firmly tightened.

2

AVOID TRAPPING SILICONE HOSE BETWEEN STUD & BRAIDED HOSES

SILICONE TUBE HOT FEED BACK TO THE TAP

G3/8" FEED TO HEATER TANK THROUGH FILTER

G1/2" COLD IN (BLUE)

G1/2" HOT IN (RED)

SILICONE TUBE RETAINER CLIP

Connections to the heater tank:

- Once the mains connections are made fit the G3/8" braided hose to the tank as shown left & below.
- Connect the silicone tube to the barbed connection on the top of the heater tank as shown left & below. **(SEE NOTE 3)**

IMPORTANT: During installation the tank should remain unplugged. The tank must be filled with water before power is connected. A 'dry start' will void the warranty.

Avoid kinking tubes during installation as the resulting restrictions could reduce flow and cause malfunctioning of the expansion chamber. Do not use pipe sealing compounds on any connections. These can foul the internal mechanics and may cause objectionable taste and odor. Plumbing connections must comply with all sanitary, safety and plumbing codes.

3 Silicone Hose

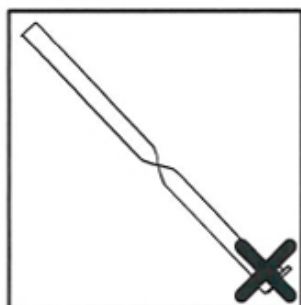
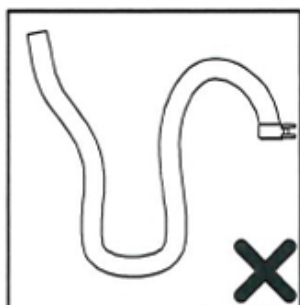
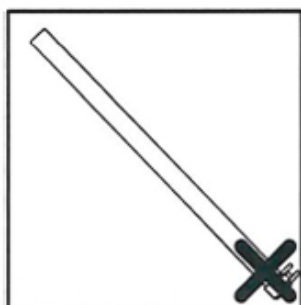
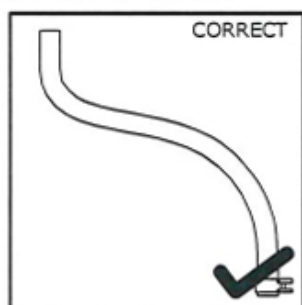

Trim the silicone hose to the right length for the installation. It must not be pulled taut, too slack leading to a 'U' bend or twisted. Please make sure the tube isn't pinched between the threaded stud and the braided hose as this may cause flow restriction. If the silicone is not installed correctly it may effect the performance of the system.

4 Operation

Instant hot water rotate left hand lever backwards

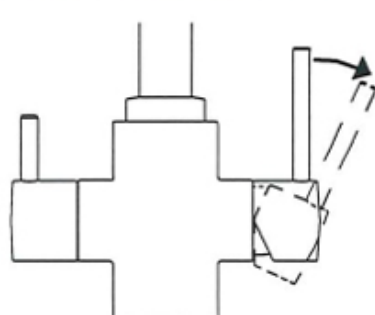
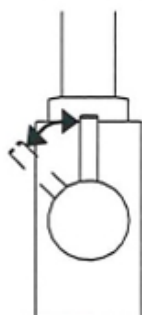

For mixed water pull away from the body. Rotate backwards for mains hot & forwards for mains cold.

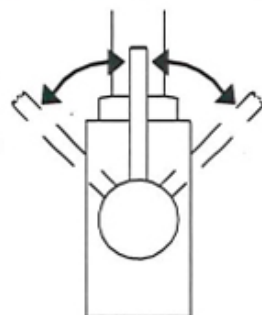

IMPORTANT BEFORE USE

- Carefully check the installation for leaks.
- If further building work is to be carried out in the vicinity, cover the product with a plastic bag to avoid damaging the finish.
- Please ensure that the installation complies with local plumbing codes.

Your product has been manufactured to exacting standards. However, in the unlikely event that you should experience any defect, the following guarantees will apply:

The tap is guaranteed against any material or workmanship defect within five years of the date of purchase. Should a fault occur; a replacement part will be issued.

Working parts, including valves, seals and hoses are guaranteed for 2 years.

The surface finish of the products are guaranteed for one year from the date of purchase. This is provided our care and maintenance instructions have been followed and that no scouring or aggressive cleaning agents have been used.

This does not affect your statutory rights.

CARE & MAINTENANCE

- When cleaning the tap ensure that the tank is switched off.
- Wipe down after use to avoid water spotting and mineral build up.
- Occasional cleaning with warm soapy water, followed by a polish with a soft cloth is all that is required to keep the plated finish in good condition.

Do not use proprietary abrasive liquids, powders, or pads to clean the tap. Do not use any products with ammonia bleach or limescale remover. You will damage the plated finish and void your guarantee.

SPARES

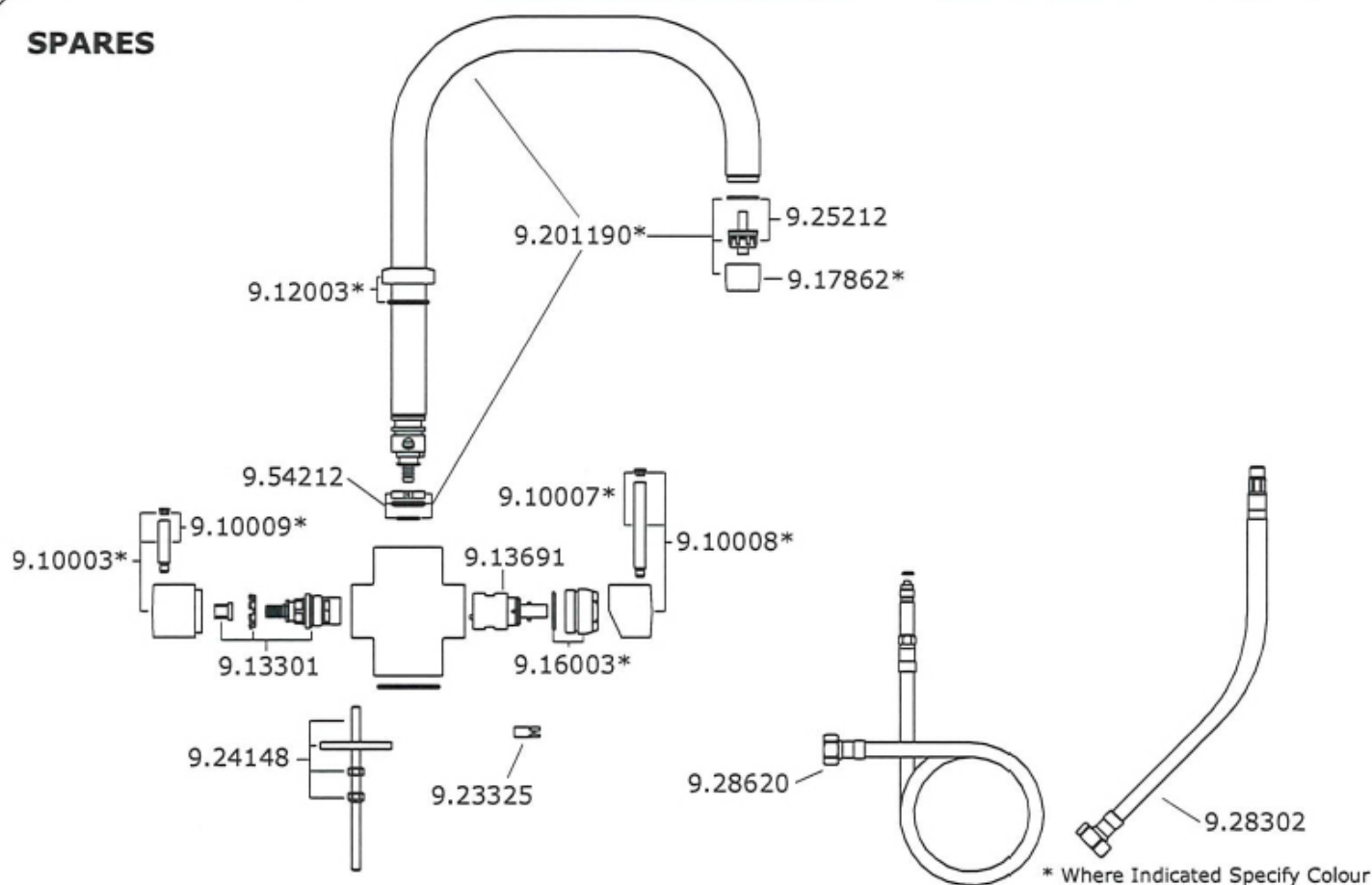

Should you require any advice, or a quick solution to a problem with this product please contact in the first instance the supplier or showroom from which it was purchased.