

Product finish	Chrome
Product category	Monobloc
First supplied date	01/03/2007

EAN 13 barcode	5015834039565
Location of DOM trace code:	ABAD3(mm/yy) on rear of base plinth



Nb. Model shown may not be displayed in the finish as described.

Product features:

- Metal construction throughout
- Custom designed for lower to mid pressures
- Quarter turn handle action for precise flow control
- Antisplash spout supplied as standard
- Modern minimalism with flair

Additional information / Parts included:

Product dimensions & valve type:

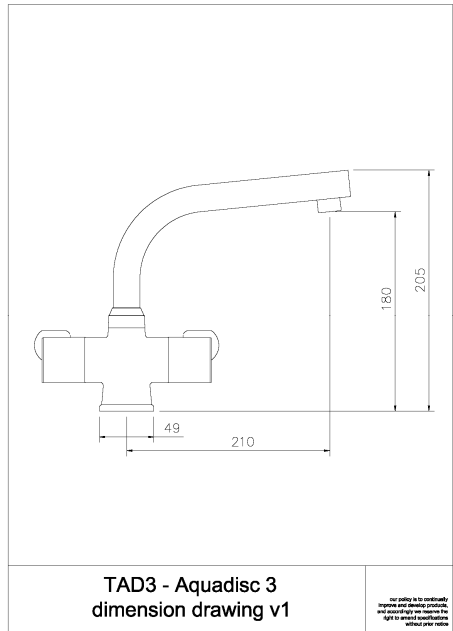

- Overall Height / projection: 205 mm
- Exit reach: 210 mm
- Exit height: 180 mm
- Centre distance(s): N/A mm
- Base diameter(s): 49 mm
- Reccomended fixing hole diameter: Ø35 mm
- Max. surface fixing depth: 30 mm
- Control valve type: 1/2" Quarter turn ceramic disc
- Valve detail: 8-20
- DDA compliant design? No

Product flow characteristics:

	0.1	0.2	0.3	0.4	0.5	0.75	1	1.5	2	2.5	3	4
Hot water	1.95	4.43	5.56	6.85	7.55	9.77	11.42	14.30	18.55	22.45	25.81	28.81
Cold water	1.93	3.49	4.44	5.47	6.09	8.02	9.30	10.14	11.80	13.02	14.31	15.55
Mixed water	2.85	6.15	7.65	9.45	10.81	13.87	16.20	19.63	22.83	26.80	29.50	32.72
Fitted water												
Sprayed water												
Other (see note 1)	2.49	4.82	5.81	7.85	8.81	11.07	13.01					
Other (see note 2)												

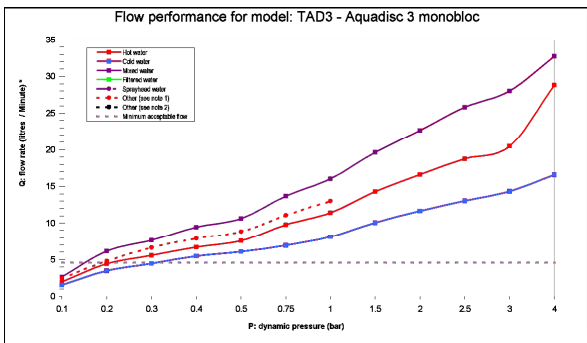



note 1: hot flow only, using low pressure aerator

note 2:

- Min / Max water pressure: 0.20 / 5.50 bar
- Recommended / Maximum water temperature: 46°C / 70°C
- Part G: Unrestricted mixed flow rate, 3 bar (litres / min): 28.00

*Flow results are produced under test conditions and represent the non flow regulated dynamic output of the product model.

TFRV02 Flow restrictor  maximum inlet flow 4l/min (8l/min mixed flow) recommended min. pressure 2.0 bar	TFRV01 flow restrictor (low pressure)  maximum inlet flow 4l/min (8l/min mixed flow) recommended min. pressure 0.75 bar
Yes	Yes

Inlet pipes:

- **Tail pipe inlet / outlet size:** M12x1 / 15mm outside diameter
- **Inlet pipe type / length:** Copper rigid tube / 245 mm

Spout detail & Flow characteristics:

- | | |
|--|--|
| <ul style="list-style-type: none"> • Spout diameter: 22 mm • Spout aerator size: M18x1M • Spout rotation range: 360° • Aerator type: Honeycomb Aerator • Aerator colouring: Neoperl HC grey & white • Spout connection: Spout locking collar | <ul style="list-style-type: none"> • Product flow characteristics: Dual flow • Non return valve (NRV) supplied: No, none supplied • NRV required to be installed for byelaw compliance: None |
|--|--|

Product markings and indicators:

- **Branding position:** 'Rangemaster' Laser marked base plinth front
- **Hot / Cold indication:** Red & Blue Screen Printed Dots On Handle Top

Packaged properties:			
Box length: 420 mm	Box depth: 75 mm	Tap only weight: 1.20 kg	
Box width: 235 mm	Units per outer: 5	Boxed weight: 1.65 kg	
Box has 'pressure warning sticker' ?	No	Total card weight: 216 grams	
Packaging branding:	Brown Rangemaster with black print	Total plastics weight: 33 grams	

- **Approval certificate number:**
- **Expiry date:**

Warranty Summary (Full details available on request):

- Materials and workmanship defects warranted for 5 years
- Valves and working parts warranted for 5 years
- Surface warranty defects warranted for 5 year
- O-rings, hoses & gaskets warranted for 5 years

Care instructions:

- Clean the mixers and showers regularly as required, using soap, do not use any other cleaners.
- Regular cleaning will prevent the build up of lime scale and dirt
- After cleaning rinse thoroughly with clean water to remove any cleaner residue
- Residues of sink & worktop cleaners can also cause damage, so rinse with clean water after using, avoid contact with any abrasives