



Product features:

- Metal construction throughout
- Thermostatic valve for safety & comfort
- Custom designed for lower range pressures
- Single spray pattern showerhead
- Smoothflex shower hose for stylish durability

Packaged properties:

Box length: 565 mm **Box depth:** 80 mm
Box width: 300 mm **Boxed weight:** 5.61 kg

Includes pop up waste?: No

Additional comments:

Includes fixed shower bracket & round showerhead

Product dimensions:

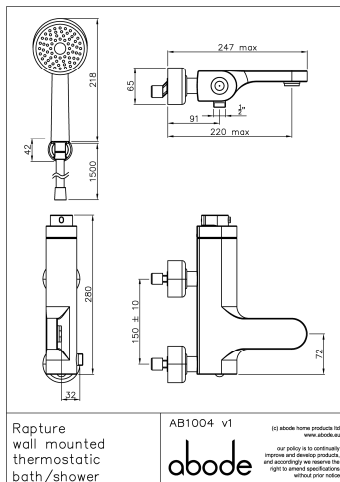

- **Overall Height / projection:** 247 mm
- **Exit reach:** 220 mm
- **Exit height:** 32 mm
- **Centre distance(s):** 150 ± 10 mm

- **Base diameter(s):** 67 mm
- **Product mounted where:** Wall
- **Recommended hole diameter:**
- **Min. fitting depth required:** 60 mm
- **Max. surface depth:**

Product flow characteristics:

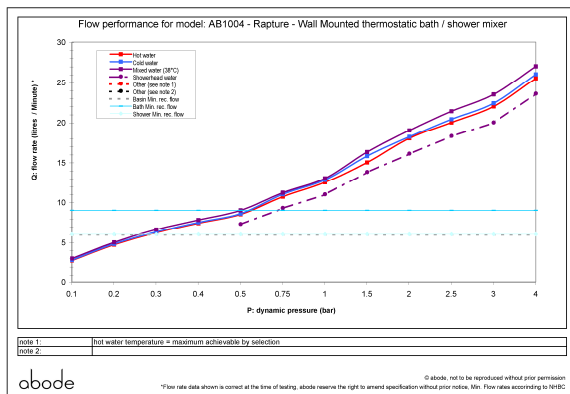

- **Min / Max water pressure:** 0.5 / 5 bar
- **Part G mixed flow rate at 3 bar (l/m):** bath=23.5, shower=20.00

- **Max water temperature:** 70° C
- **Product flow characteristics:** Single flow
- **Aerator type:** White flow straightener
- **Includes output diverter?:** Yes
- **Control valve type:** Thermostatic ()
- **Non return valve position:** h&c inlet
- **Mesh particle filter size:** 0.60 mm
- **Inlet / outlet size:** 1/2" M / 3/4" M
- **Inlet type / length:** Eccentric / 45 mm
- **Shower hose type / length:** Smoothflex / 1.50 m

Warranty Summary (Full details available on request):

- Materials and workmanship defects warranted for 5 years
- Valves and working parts warranted for 5 years
- Surface warranty defects warranted for 1 year
- O-rings, hoses & gaskets warranted for 1 year

Care instructions:

- Clean the mixers and showers regularly as required, using soap, do not use any other cleaners.
- Regular cleaning will prevent the build up of lime scale and dirt
- After cleaning rinse thoroughly with clean water to remove any cleaner residue
- Residues of liquid soaps, shampoos and shower foams can also cause damage, so rinse with clean water after using, avoid contact with any abrasives